

CAPITOLUL B
PIESE DESENATE

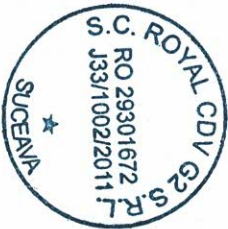

CONTINUT

Descriere	Plansa numarul	Scara
Obiect 1: Modernizare Strada Jozsef Attila		
Plan de amplasare in zona	PA-01	1:10000
Profile transversal tip	PTT-01...PTT-03	1:50
Plan de situatie – situatia existenta	PSE-01 ...PSE-03	1:500
Plan de situatie – solutia proiectata	1_PS-01 ...1_PS-05	1:500
Profil longitudinal	1_PL-01...1_PL-03	1:1000/1:100
Obiect 2: Extindere canalizare menajera strada Jozsef Attila		
Plan de situatie canalizare menajera	2_PS-01...2_PS-02	1:500



PLAN DE AMPLASARE



Strada Jozsef Attila



Proiectant		Beneficiar		Verificator / Expert		Faza		Revizia	
ROYAL CDV G2		Municipiul Sfântu Gheorghe		Ing. Jitranic Robert		D.A.L.I.		00	
RO29301672, Suceava, Romania		Jud. Covasna		Ing. Francisc Vasile		Scara		Format	
				Ing. Calancea Darius		1:10000		A3	
				Proiect nr. 13 - 2017		Titlu planşa		Planşa nr.	
				Data august 2017		Plan de amplasare in zona		PA-01	

PROFILE TRANSVERSAL TIP

PROFIL TRANSVERSAL TIP 1

Se aplica pe:
Strada principala de la km 0+000 - 0+308

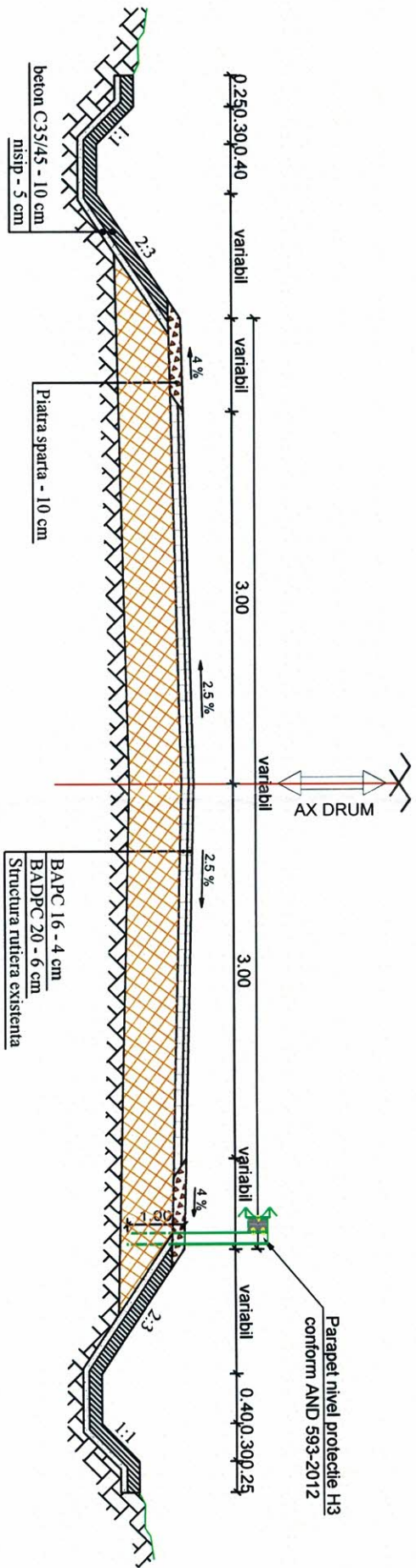

NOTA:
-parapetul nivel protectie H3 se va dispune de la km 0+165 pana la km 0+308;
-santurile de beton se vor dispune conform planurilor de situatie acolo unde au fost prevazute.



Proiectant		Beneficiar		Verificator / Expert		Cantina		Faza		Titlu proiect		Revizia	
ROYAL CDV G2		Municipiul Stăntu Gheorghe		Self proiect				D.A.L.I.		Modernizare str. Jozsef Attila inclusiv rețele tehnico-edilitare etapa III		00	
RO29301672, Suceava, Romania		Jud. Covasna		Proiectat		ing. Jitaiuc Robert		Scara		Titlu planșa		Format	
				Proiectat		ing. Francisc Vasile		1:50		Profile transversale tip		A3	
				Proiectat		ing. Calancea Darius						Planșa nr.	
				Proiect număr 13 - 2017		Data august 2017						PTT-01	

PROFILE TRANSVERSAL TIP

PROFIL TRANSVERSAL TIP 2

Se aplica pe :
Strada adiacenta 207.00 m de la km 0+000 - 0+030

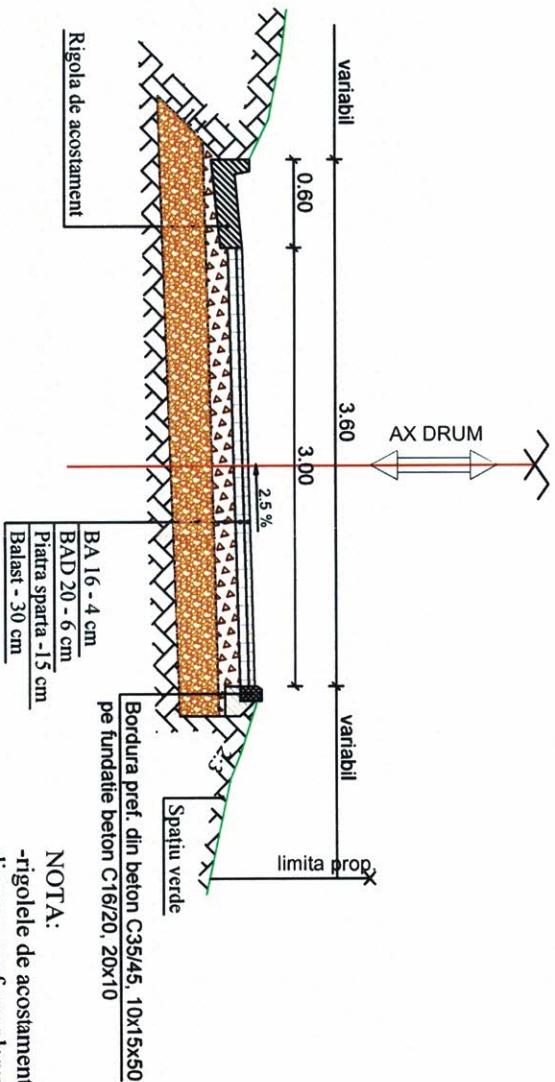

NOTA:
-rigolele de acostament realizate din beton monolit se vor dispune conform planurilor de situatie acolo unde au fost prevazute;
-in dreptul acceselor la proprietati rigolele de acostament se vor adopta astfel incat sa fie permis accesul auto in mod facil.

PROFIL TRANSVERSAL TIP 3

Se aplica pe :
Strada adiacenta 207.00 m de la km 0+030 - 0+207

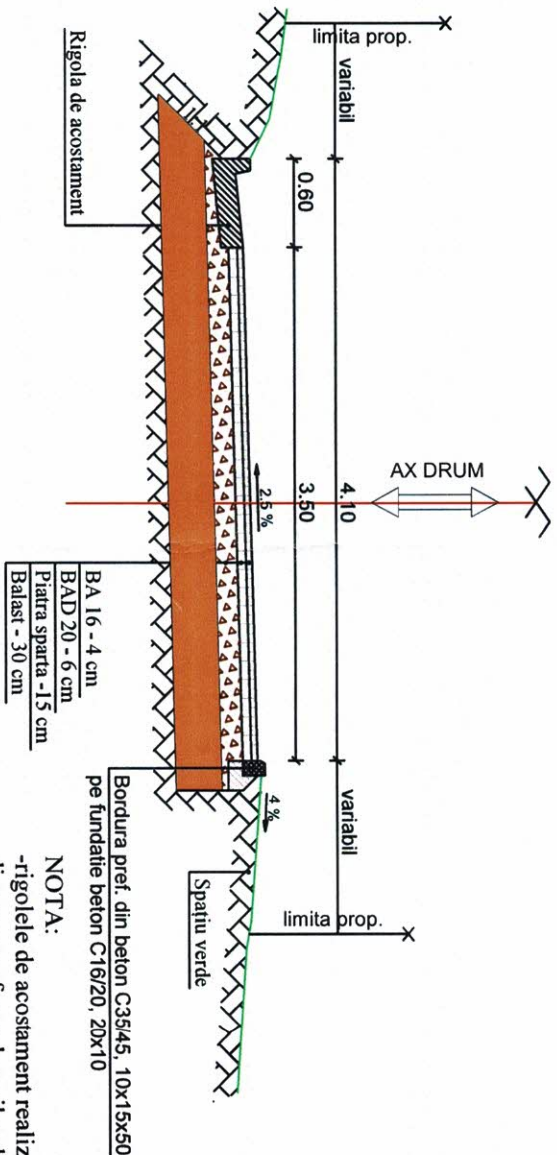

NOTA:
-rigolele de acostament realizate din beton monolit se vor dispune conform planurilor de situatie acolo unde au fost prevazute;
-in dreptul acceselor la proprietati rigolele de acostament se vor adopta astfel incat sa fie permis accesul auto in mod facil.



Proiectant		Beneficiar		Verificator / Expert		Faza		Titlu proiect		Revizia	
ROYAL CDV G2		Municipiul Sfantu Gheorghe		ing. Jitairnic Robert		D.A.L.I.		Modernizare str. Jozsef Attila inclusiv rețele tehnico-edilitare etapa III		00	
RO29301672, Suceava, Romania		Jud. Covasna		ing. Francisc Vasile		Scara		Titlu planșa		Format	
				ing. Calancea Darius		1:50		Profile transversale tip		A3	
				Proiect nr. 13 - 2017		Data				Planșa nr.	
				august 2017						PTT-02	

PROFILE TRANSVERSAL TIP

PROFIL TRANSVERSAL TIP4

Se aplica pentru :
Strada adiacenta in lungime de 50,25 m

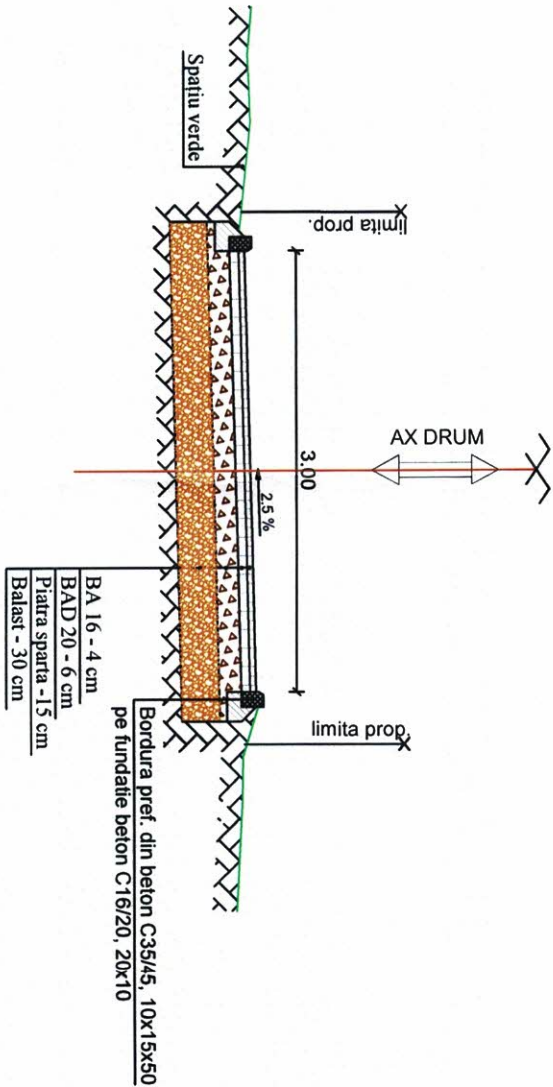

PROFIL TRANSVERSAL TIP5

Se aplica pentru :
Amplasare strada laterala (de pe strada principala) pe o lungime de 10,00 m
la poz. km 0+093,00

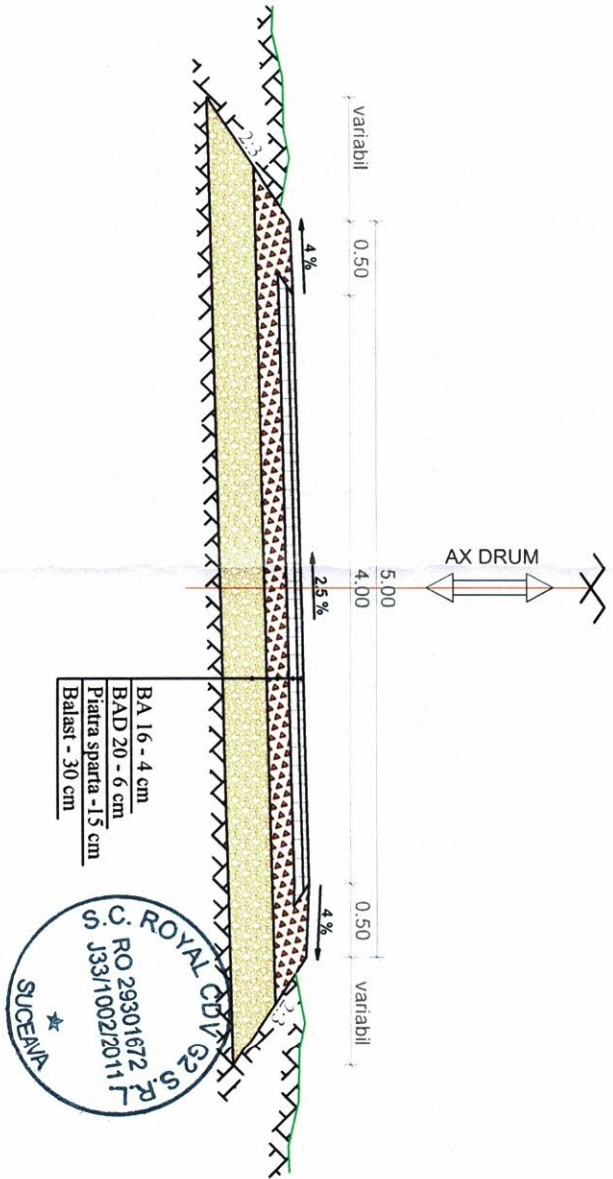

Proiectant		Beneficiar		Verificator / Expert		Cerinta		Faza		Titlu proiect		Revizia	
ROYAL CDV G2		Municipiul Stăntu Gheorghe		Set proiect		ing. Jilariu Robert		D.A.L.I.		Modernizare str. Jozsef Attila inclusiv rețele tehnico-edilitare etapa III		00	
RO29301672, Suceava, Romania		Jud. Covasna		Proiectat		ing. Francisc Vasile		Scara		Titlu planșa		Format	
				Proiectat		ing. Calaneca Darius		1:50		Profile transversale tip		Planșa nr.	
				Proiect număr 13 - 2017		Data august 2017						PTT-03	

Obiect 1:Modernizare Strada Jozsef Attila



PLAN DE SITUATIE - SITUATIA EXISTENTA

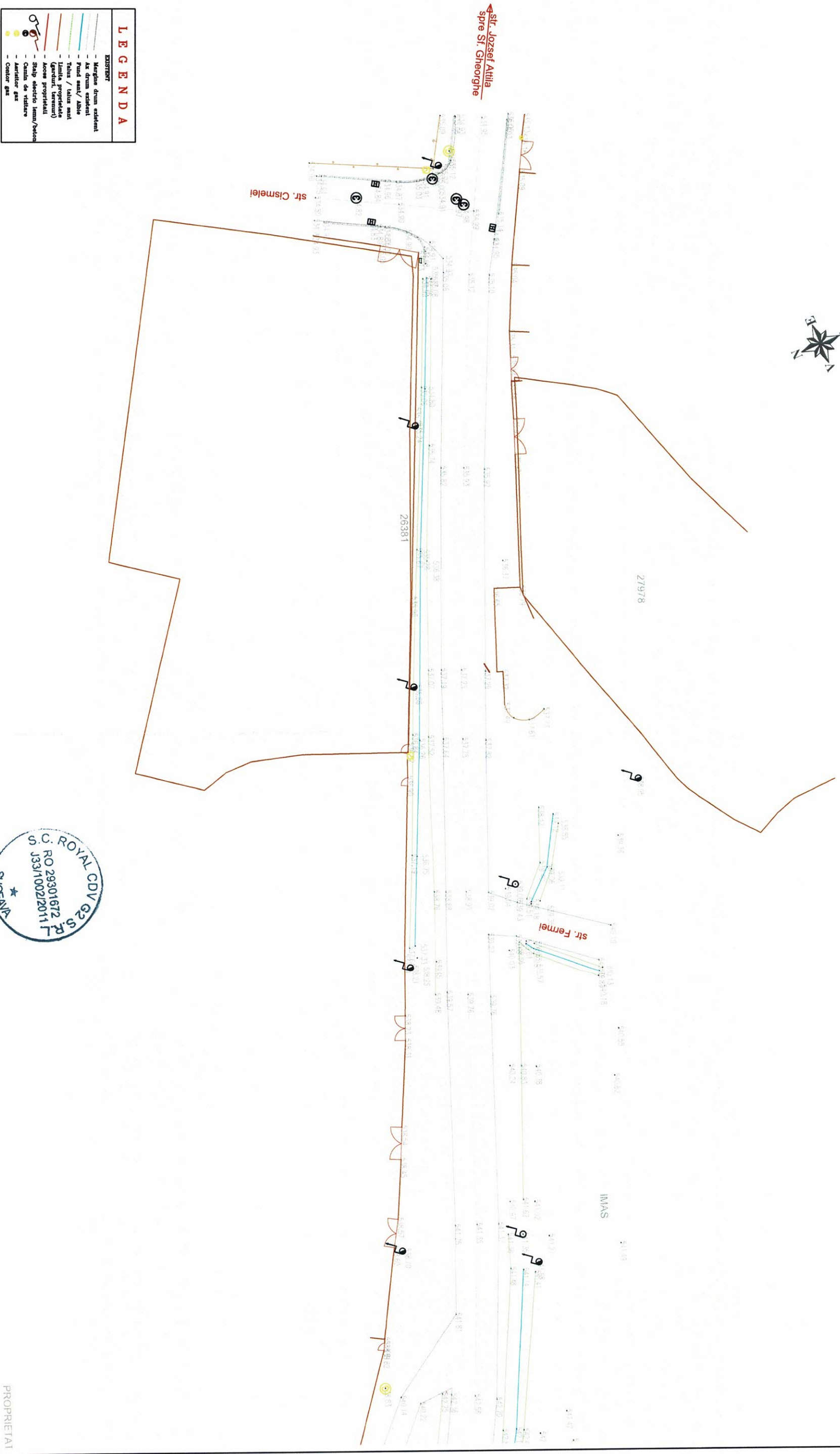

PROPRIETAT

Proiectant		Beneficiar		Verificator / Expert		Revizia	
<div>ROYAL CDV G2</div> <div></div> <div>RO29301672, Suceava, Romania</div>		Municipiul Sfântu Gheorghe Jud. Covasna		Centra		00	
				Faza		Titlu proiect Modernizare str. Jozsef Attila inclusiv rejele tehnico-edilitare etapa III	
				D.A.L.I.			
				Scara			
Proiectat		ing. Jltariuc Robert		Titlu plansa		Plan de situatie - Situatia existenta	
Proiectat		ing. Francisc Vasile					
Proiectat		ing. Calancea Darius					
Proiect numar		13 - 2017		Data		august 2017	
						PSE-01	

PLAN DE SITUATIE - SITUATIA EXISTENTA

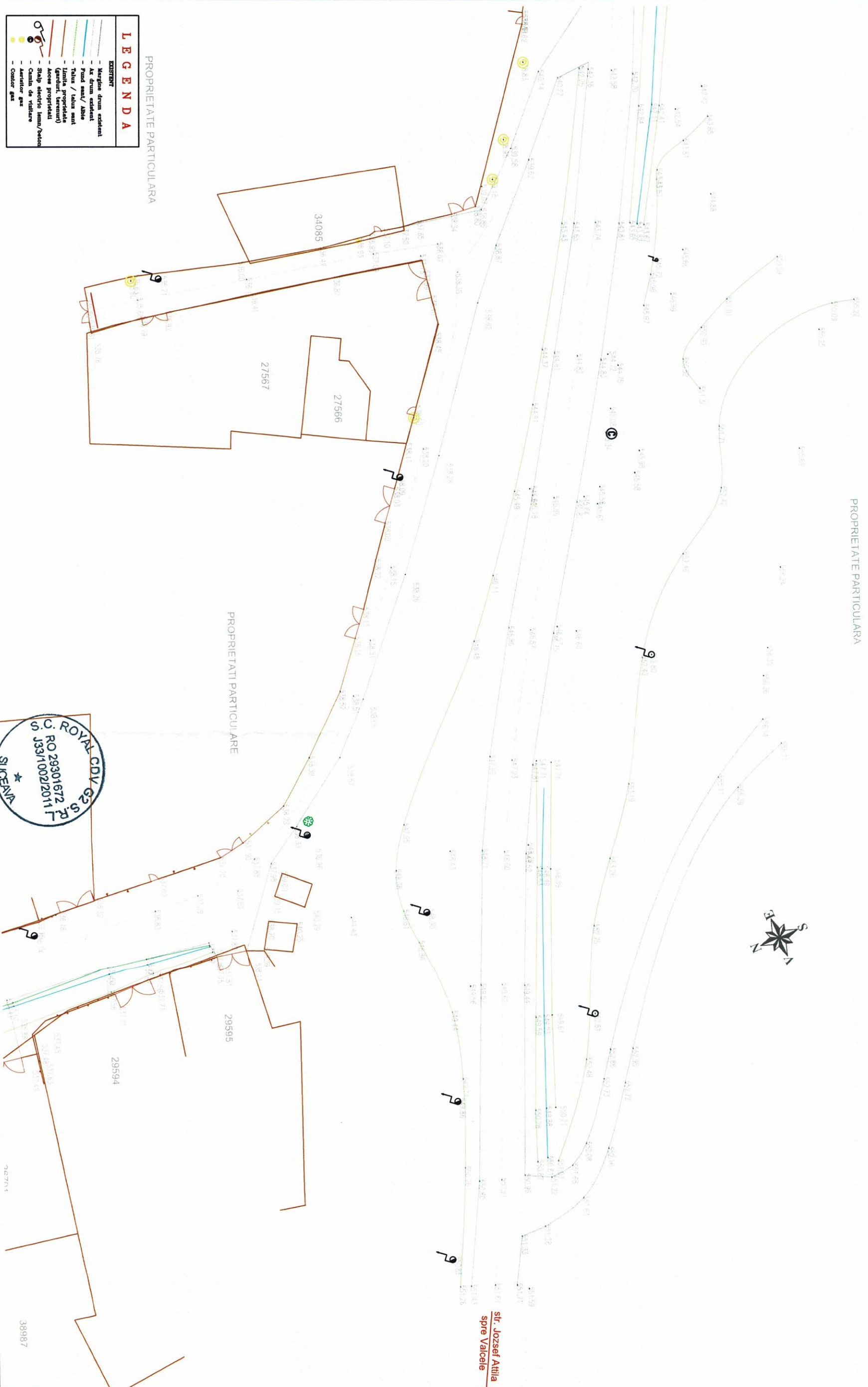

LEGENDA

EXISTENT

- Margine drum existent
- Ar drum existent
- Fund sant/ Abis
- Taluz / taluz sant
- Limita proprietate (garduri, terenuri)
- Acces proprietati
- Stalp electric lamn/velon
- Camin de vizitare
- Arzator gaz
- Contor gaz



Protectant		Beneficiar		Verificator / Expert		Faza		Titlu proiect		Revizia	
ROYAL CDV G2		Municipiul Sântu Gheorghe		Ing. Jltanuc Robert		D.A.L.I.		Modernizare str. Jozsef Attila inclusiv rețele tehnico-edilitare etapa III		00	
RO29301672, Suceava, Romania		Jud. Covasna		Ing. Francisc Vasile		Scara		Titlu planșa		Format	
				Ing. Calancea Darius		1:500		Plan de situatie - Situatia existenta		A3	
				Proiect numar 13 - 2017 Data august 2017						Planșa nr.	
										PSE-02	

PLAN DE SITUATIE - SITUATIA EXISTENTA

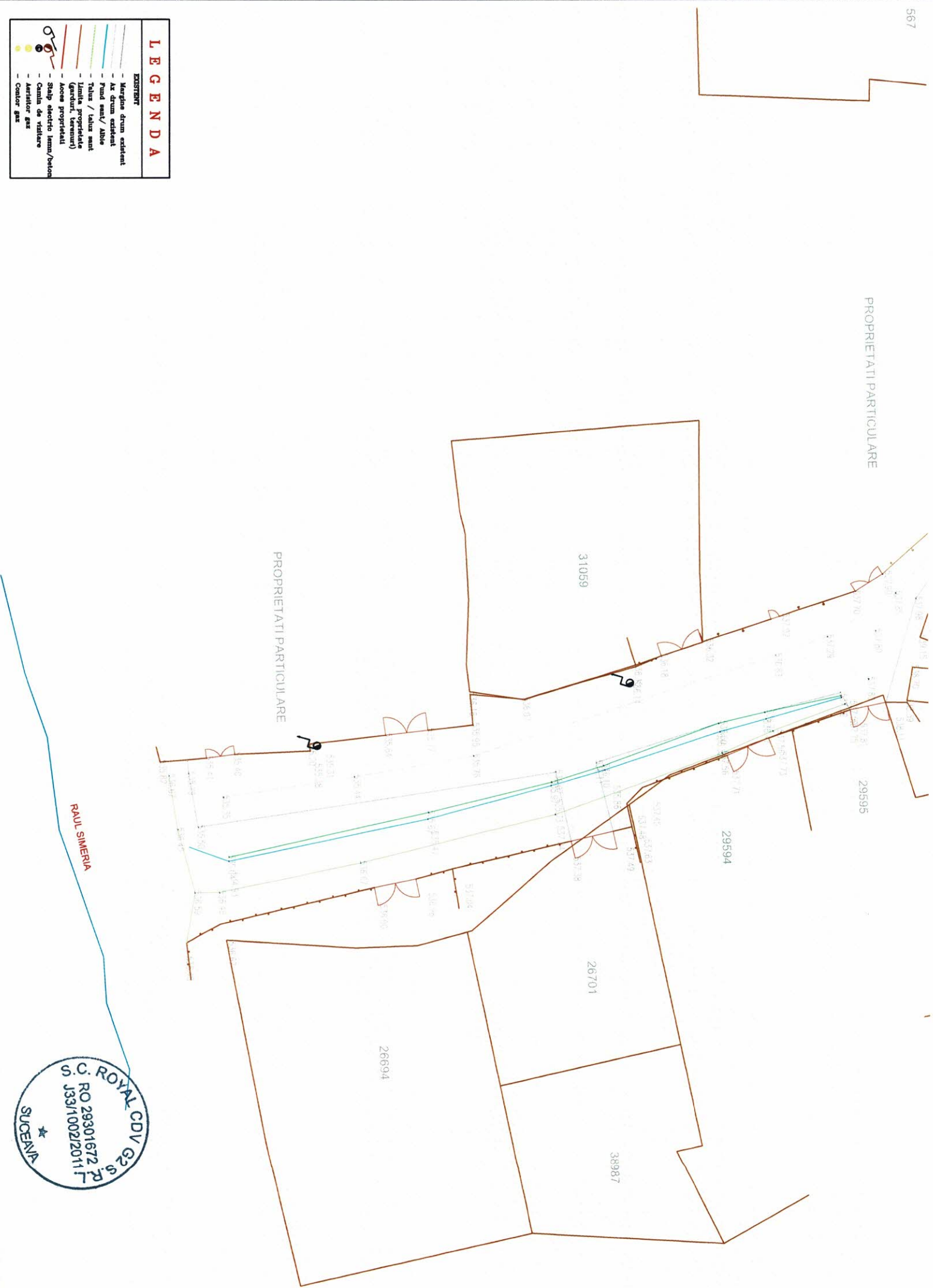

Proiectant		Beneficiar		Verificator / Expert		Cerinta		Titlu proiect		Revizia	
ROYAL CDV G2		Municipiul Sfantu Gheorghe		Set proiect		Ing. Jitencu Robert		D.A.L.I.		00	
RO29301672, Suceava, Romania		Jud. Covasna		Proiectat		Ing. Francisc Vasile		Scara		Format	
				Proiectat		Ing. Calancea Darius		1:500		A3	
				Proiect numarul		13 - 2017		Data		august 2017	
										Plan de situatie - Situatia existenta	
										PSE-03	

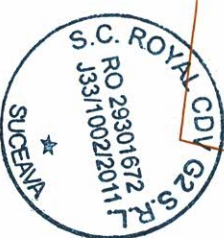

yrkm/h	20
U	167.5544g
Rlim	7.000
Tlim	3.116
Telml	3.116
lit	2.500
Coorn	
Vcb	484
Va	484
Ti	484
Tai	484
Tae	484
Te	484

L E G E N D A	
<p>EXISTENT</p> <ul style="list-style-type: none"> — Margite drum existent — Ar drum existent — Pund mnt/ Albe — Tabu / tabu ant — Lanta porpalede (gaurat, venant) — Acora propriatati — Stalp dectre luma/velon — Carmin de valitare — Arstilor gas — Contilor gas 	<p>PREDICTAT</p> <ul style="list-style-type: none"> — Coconabli — lococament — Ar drum — Sant — Bordura mico 10x16 — Spatul verde

Proiectant		Beneficiar		Verificator / Expert		Faza		Titlu proiect		Revizia	
ROYAL CDV G2		Municipiul Sântu Gheorghe Jud. Covasna		Ing. Jitaruc Robert		D.A.L.I.		Modernizare str. Jozsef Attila inclusiv rețele tehnico-edilitare etapa III		00	
RO29301672, Suceava, Romania				Ing. Francisc Vasile		Scara		Titlu planșă		Format	
				Ing. Calancea Darius		1:500		Obiect 1: Modernizare strada Jozsef Attila		A3	
										Planșă nr. 1_PS-01	
				Proiect număr 13 - 2017							
				Data august 2017							

PLAN DE SITUATIE - SOLUTIA PROIECTATA



2		50	L(lin)	L(e)	0,000
U	187,488g	L(e)	0,000		
R(m)	270,000	C(m)	53,028		
T(m)	26,599	h(m)	25,000		
T(e)	26,599	h(m)	25,000		
f(%)	2,500	h(m)	25,000		
Coordonate					
Va	484311,954N	559547,142E			
Va	484311,954N	559547,142E			
Ti	484302,011N	559571,813E			
Ta	484302,011N	559571,813E			
Ta	484326,520N	559524,885E			
Te	484326,520N	559524,885E			

3		50	L(lin)	L(e)	0,000
U	189,764g	L(e)	0,000		
R(m)	270,000	C(m)	43,614		
T(m)	21,855	h(m)	25,000		
T(e)	21,855	h(m)	25,000		
f(%)	2,500	h(m)	25,000		
Coordonate					
Va	484387,245N	559462,657E			
Va	484387,245N	559462,657E			
Ti	484355,278N	559480,943E			
Ta	484355,278N	559480,943E			
Ta	484376,116N	559442,883E			
Te	484376,116N	559442,883E			

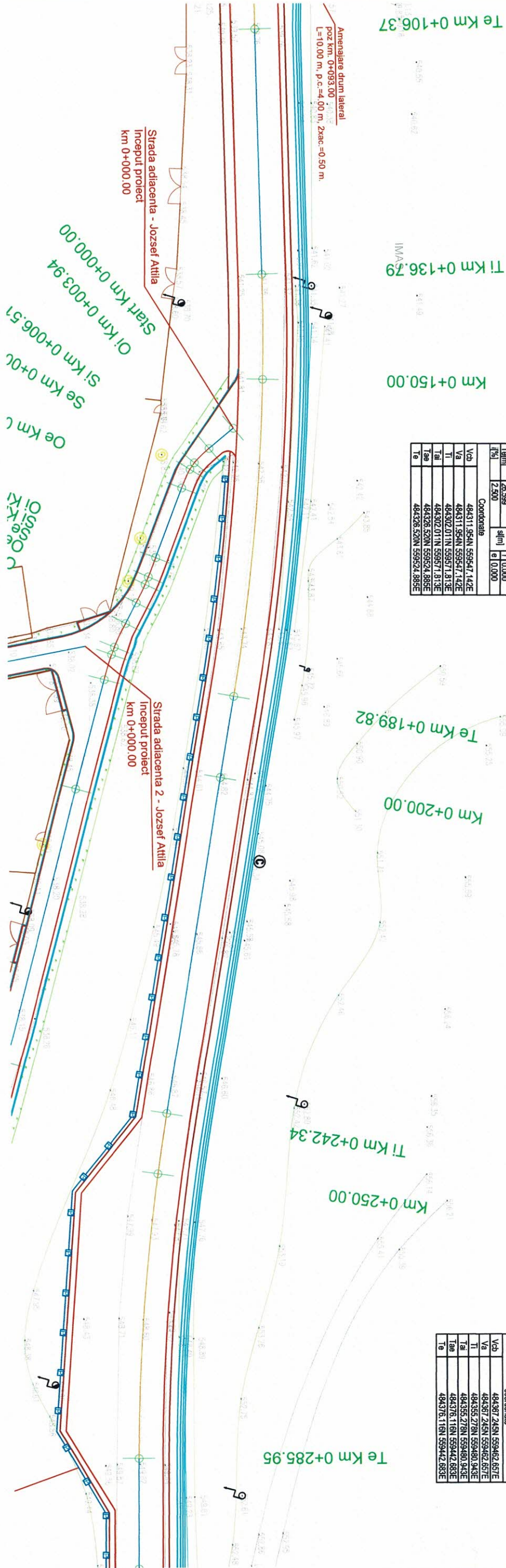

LEGENDA	
EXISTENT	PROIECTAT
- Margine drum existent	- Carosabil
- Ac drum existent	- Acordament
- Pund meci/ Albie	- Ac drum
- Taluz / taluz scut	- Scut
- Taluz / taluz scut	- Bordura mal 10x15
- Linia proprietate (garduri, terenuri)	- Spatiu verde
- Acce proprietați	
- Stalp electric lemn/beton	
- Cămin de vizitare	
- Aerator gaz	
- Cămin de vizitare	

Proiectant	Beneficiar	Verificator / Expert	Cerinta	Faza	Titlu proiect	Revizua
ROYAL CDV G2	Municipiul Sfântu Gheorghe Jud. Covasna	Ing. Jitlanuc Robert Ing. Francisc Vasile Ing. Calancea Darius		D.A.L.I. Scara 1:500	Modernizare str. Jozsef Attila inclusiv rețele tehnico-edilitare etapa III Titlu planșa	00 Format A3 Planșa nr. 1_PS-02
RO29301672, Suceava, Romania		Proiect numarul 13 - 2017 Data august 2017			Obiect 1: Modernizare strada Jozsef Attila	

PLAN DE SITUATIE - SOLUTIA PROIECTATA



PROPRIETATE PARTICULARA

3					
U	50	Lini	0,000		
U	189,7164g	1,44m	0,000		
Ecni	270,000	Cm	43,614		
Tm	21,855	km	23,000		
km	21,855	km	1,000		
1%	2,500	sfm	0,000		
Coordonate					
Vd	484387,245N	559462,857E			
Va	484387,245N	559462,857E			
Ti	484385,278N	559480,943E			
Ta	484376,116N	559442,883E			
Te	484376,116N	559442,883E			

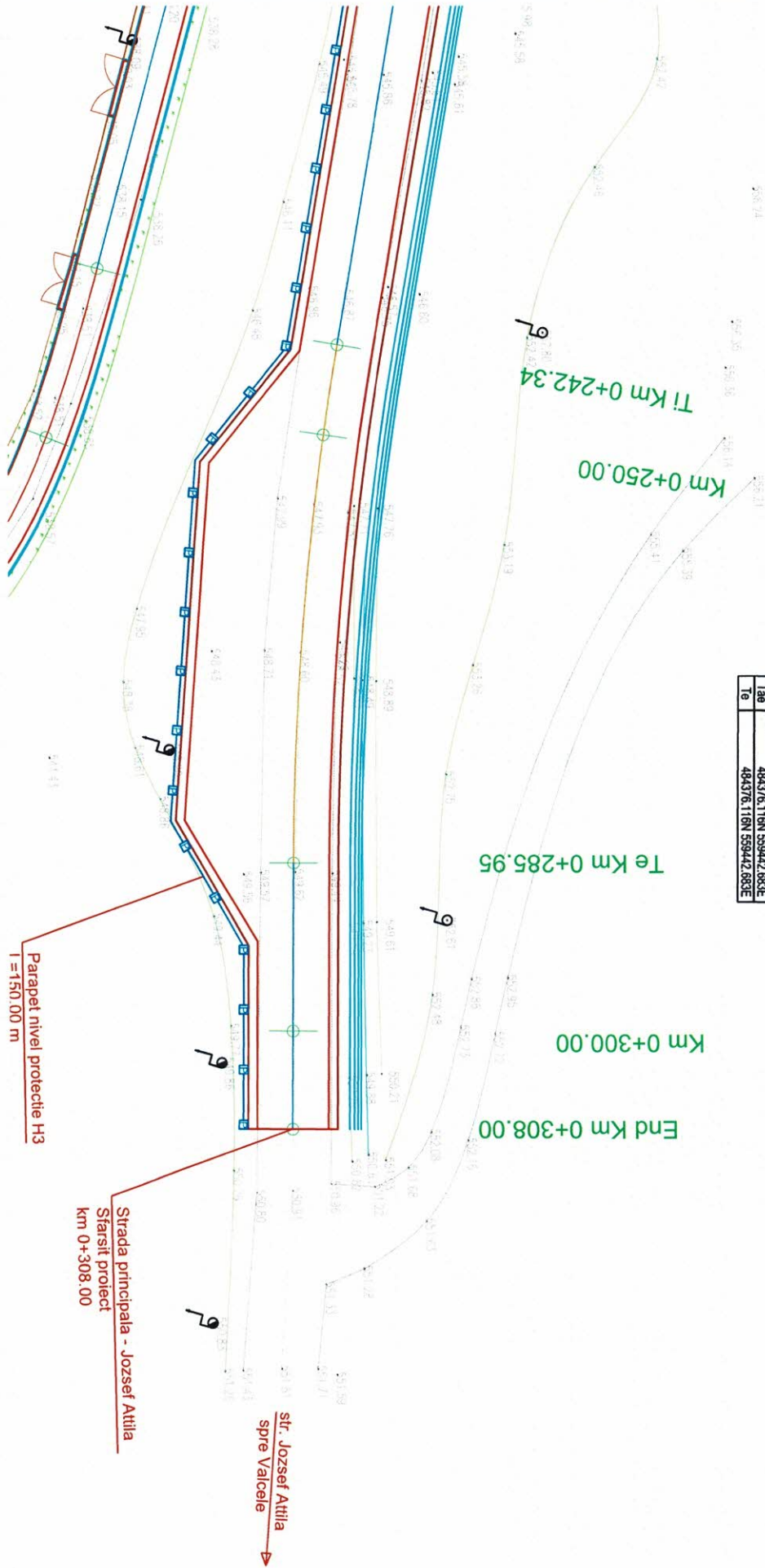

LEGENDA	
EXISTENT	PROIECTAT
- Margine drum existent	- Cosecabil
- Ax drum existent	- Acoperament
- Punct mal / Albie	- Ax drum
- Taluz / Valiza noi	- Sinal
- Linie proprietate (Linie proprietate)	- Bordura mla 10x15
- Linie proprietate	- Spalte verde
- Stalp electric linu / telefon	
- Caram da vizitare	
- Aerator gas	
- Contor gas	

Proiectant

ROYAL CDV G2

RO29301672, Suceava, Romania

Beneficiar

Municipiul Sântu Gheorghe
Jud. Covasna

Verificator / Expert

Set proiect ing. Jifanuc Robert
Proiectat ing. Francisc Vasile
Proiectat ing. Calanica Darius

Certifica

Faza

D.A.L.I.

Titlu proiect

Modernizare str. Jozsef Attila inclusiv rețele tehnico-edilitare etapa III
Scara 1:500
Titlu planșa
Obiect 1: Modernizare strada Jozsef Attila

Revizie

00

Format

A3

Planșa nr.

1_PS-03

PROFIL LONGITUDINAL

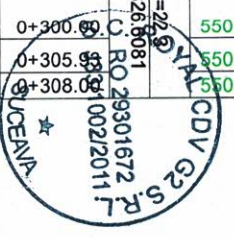
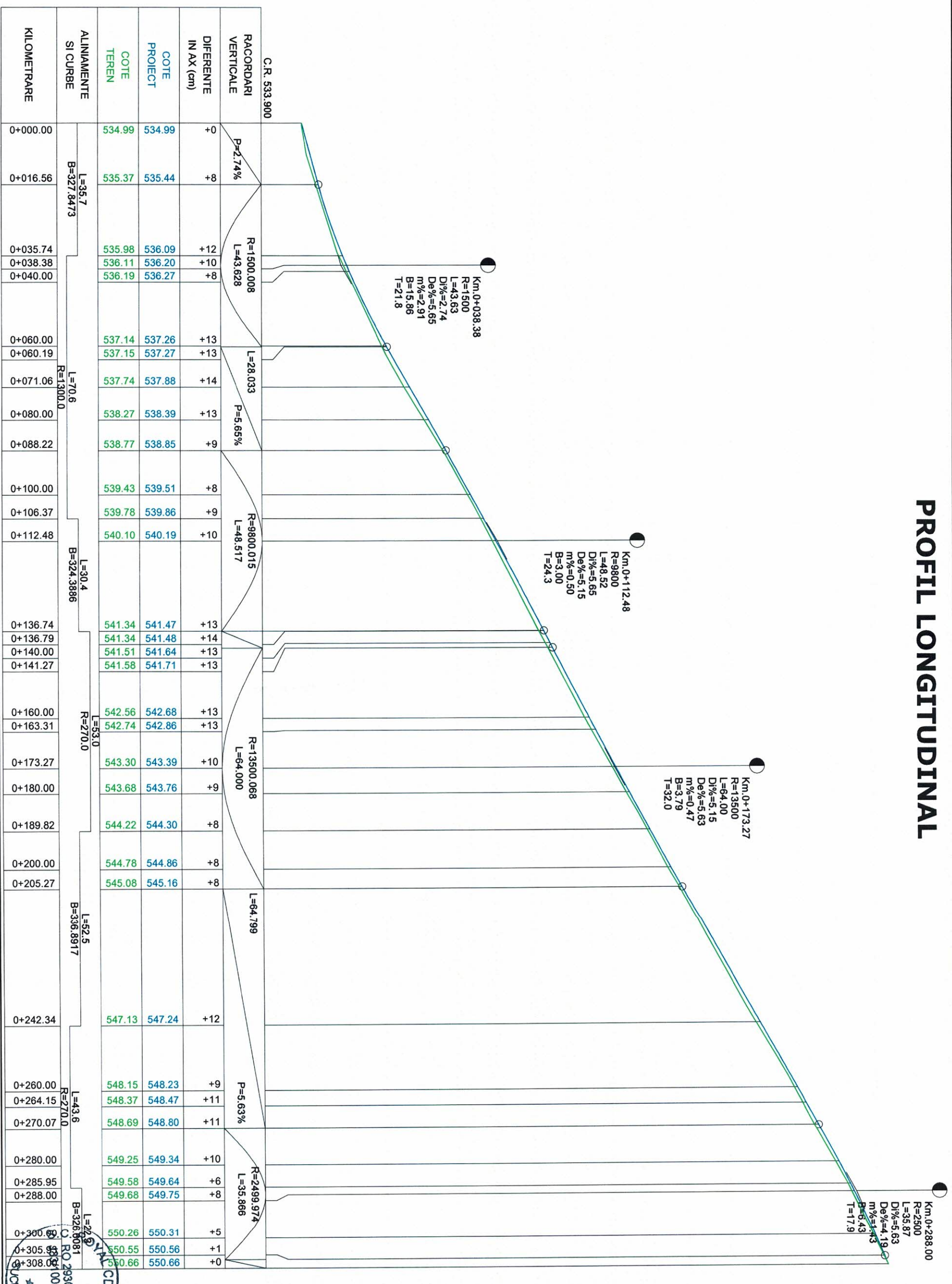

Proiectant		Beneficiar		Verificator / Expert		Cerinta		Faza		Titlu proiect		Revizie	
ROYAL CDV G2		Municipiul Sfantu Gheorghe Jud. Covasna		Sef proiect Proiectat Proiectat		ing. Jitancu Robert ing. Francisc Vasile ing. Calancea Darius		D.A.L.I. Scara 1:1000 1:100		Modernizare str. Jozsef Attila inclusiv retele tehnico-edilitare etapa III Titlu planşa		00 Format A3 Planşa nr. 1_PL-01	
RO29301672, Suceava, Romania				Proiect numar 13 - 2017		Data august 2017				Obiect 1: Modernizare strada Jozsef Attila			

PLAN DE SITUATIE - SOLUTIA PROIECTATA

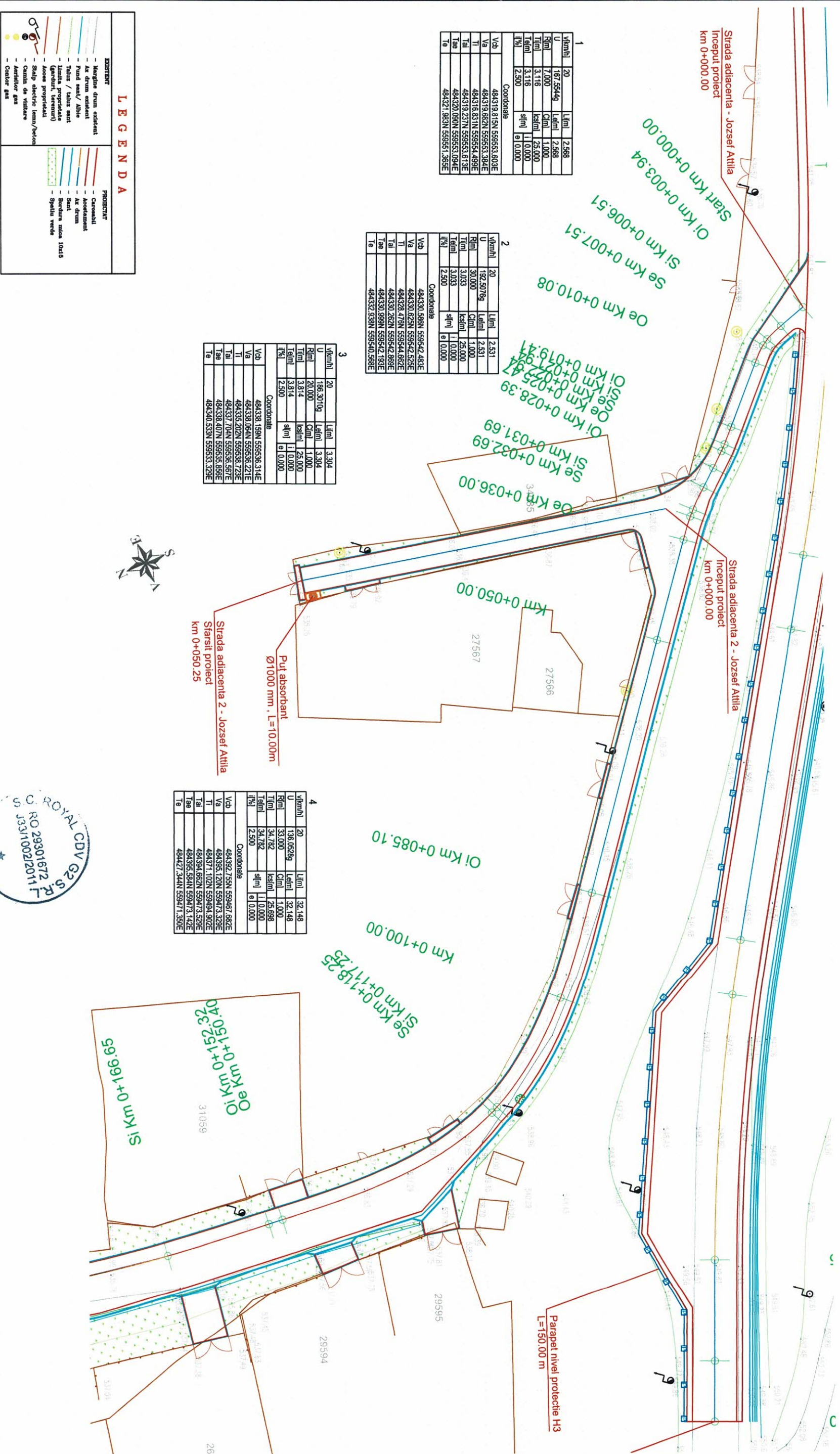
**Projectant**

Beneficiary

Verificator / Expert

Cerinta

Faza

Titlu proiect

Revizia
00

ROYAL CDV G2 

Municipiul Sfântu Gheorghe
Jud. Covasna

RO29301672, Suceava, Romania

Proiectat	ing. Calancea
-----------	---------------









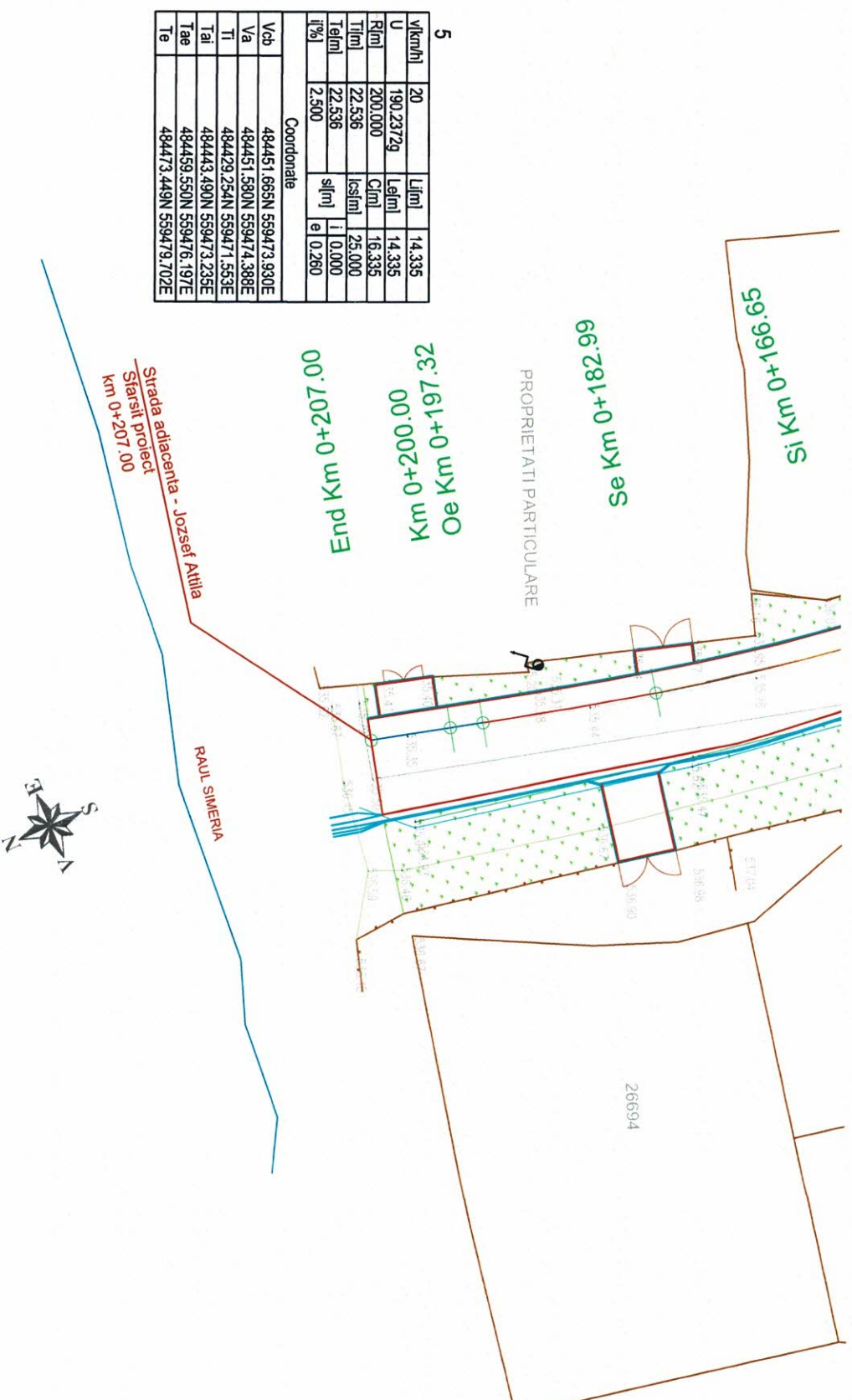





1:500

Obiect 1: Modernizare strada Jozsef Attila

1 DC-04
Plansa nr.

PLAN DE SITUATIE - SOLUTIA PROIECTATA

[illegible]

L E G E N D A	
EXISTENT	PROIBITAT
 - Marjorie d'un viciant  - Ar d'un viciant  - Pont avall / Albu  - Tèlta / Tèlta sent  - Juntia (proprietat)  - Aneu proprietati  - Ship electric /vian /vian  - Camin de vian  - Avertir gas  - Contor gas	 - Carreable  - Acromant  - Ar d'un  - Bactura mla 10at5  - Spallia verde

Proiectant		Beneficiar	
ROYAL CDV G2 		Municipiul Sîntu Gheorghe Jud. Covasna	
Verificator / Expert		Cerința	
Sef proiect		ing. Jitaruc Robert	
Proiectat		ing. Francisc Vasile	
Proiectat		ing. Calancea Darius	
Proiect număr 13 - 2017		Data august 2017	
Faza		Titlu proiect	
D.A.L.I.		Modernizare str. Jozsef Attila inclusiv rețele tehnico-edilitare etapa III	
Scara		Titlu planșa	
1:500		Obiect 1: Modernizare strada Jozsef Attila	
Revizua		Format	
00		A3	
Planșa nr. 1_PS-05		Kovacs-Diana	

PROFIL LONGITUDINAL

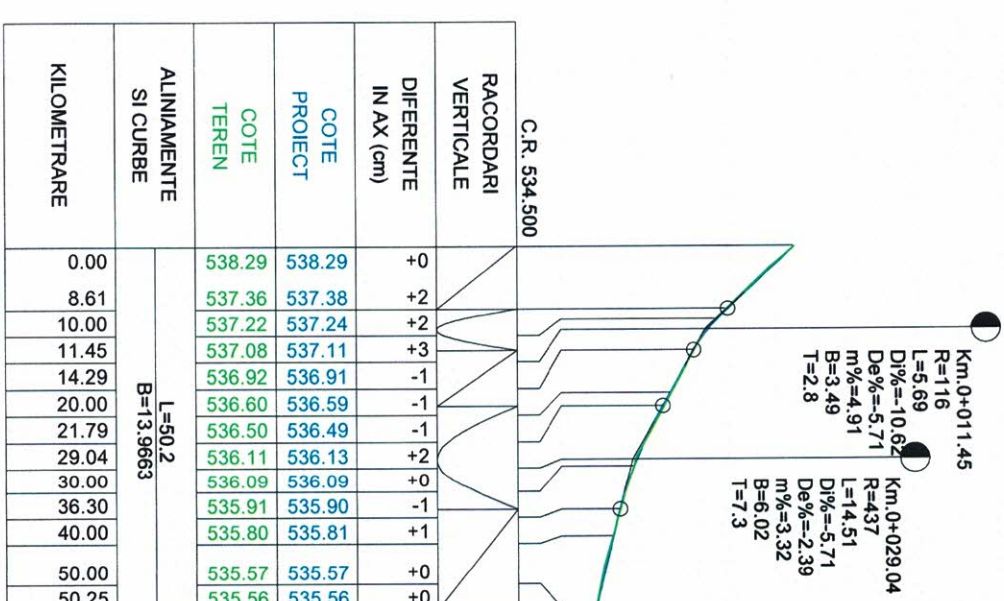
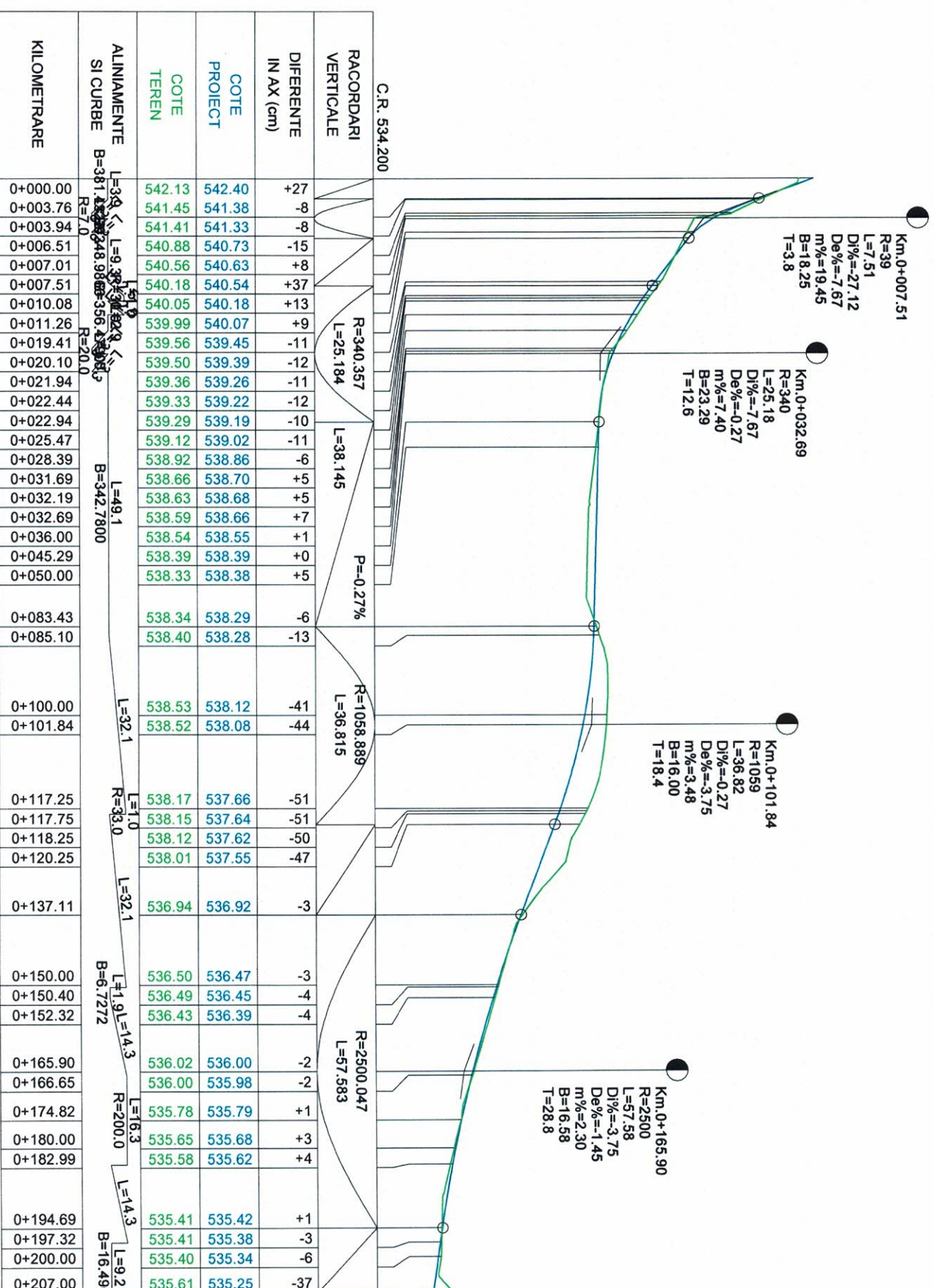

Strada adiacenta L=207.00 m

Strada adiacenta L=50.25 m

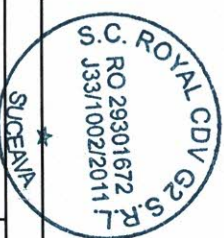

Proiectant ROYAL CDV G2	Beneficiar Municipiul Sfantu Gheorghe Jud. Covasna	Verificator / Expert Set proiect Proiectat Proiectat	Cerinta ing. Jitancu Robert ing. Francisc Vasile ing. Calancea Darius	Faza D.A.L.I. Scara 1:1000 1:100	Titlu proiect Modernizare str. Jozsef Attila inclusiv retele tehnico-edilitare etapa III Titlu planşa Obiect 1: Modernizare strada Jozsef Attila	Revizia 00 Forma A3 Planşa nr. 1_PL-02
-----------------------------------	--	---	--	--	---	---

Obiect 2:Extindere canalizare menajera strada Jozsef Attila



CONTINUT

Descriere	Plansa numarui	Scara
Obiect 1:Modernizare Strada Jozsef Attila		
Plan de amplasare in zona	PA-01	1:10000
Profile transversal tip	PTT-01...PTT-03	1:50
Plan de situatie – situatia existenta	PSE-01 ...PSE-03	1:500
Plan de situatie – solutia proiectata	1_PS-01 ...1_PS-05	1:500
Profil longitudinal	1_PL-01...1_PL-03	1:1000/1:100
Obiect 2:Extindere canalizare menajera strada Jozsef Attila		
Plan de situatie canalizare menajera	2_PS-01...2_PS-03	1:500



PLAN DE SITUATIE - CANALIZARE MENAJERA

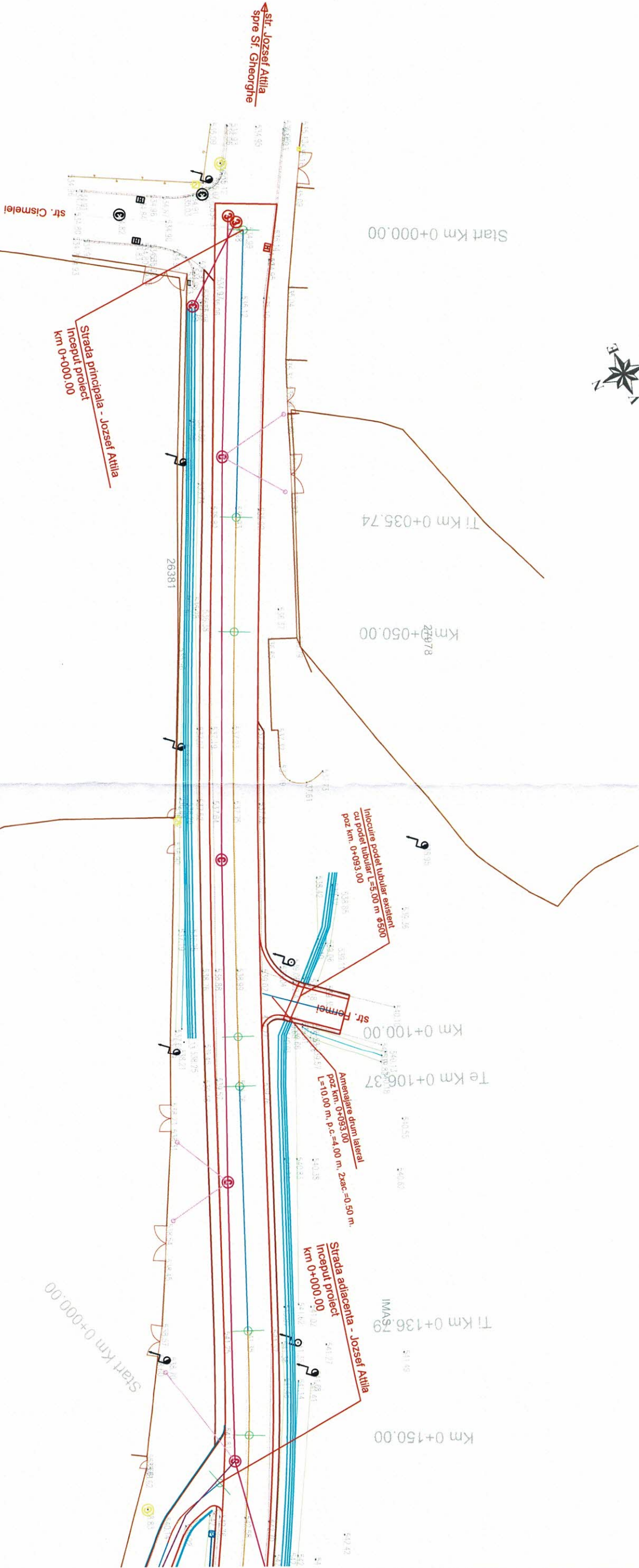

LEGENDA	
EXISTENT	PROIECTAT
- Margina drum existent	- Cursivabil
- As drum existent	- Acordament
- Punct san/ Abie	- As drum
- Taluz / taluz sant	- Sant
- Limita proprietate (genturi, versanti)	- Bordura mica 10x15
- Acove proprietati	CANALIZARE MENAJERA
- Stalp electric lemn/beton	- Conducta canaliz. menajera PE100
- Cana de vizitare	- Conducta retiliera ape uzate DW90
- Aeritor gas	- Cana de vizitare proiectat
- Contor gas	- Cana de vizitare/cana de vizitare proiect la cot

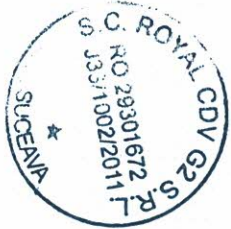

Proiectant		Beneficiar		Verificator / Expert		Centra		Faza		Titlu proiect		Revizia	
ROYAL CDV G2		Municipiul Sfântu Gheorghe		Ing. Jilencu Robert				D.A.L.I.		Modernizare str. Jozsef Attila inclusiv retele tehnico-edilitare etapa III		00	
RO29301672, Suceava, Romania		Jud. Covasna		Ing. Doroscan Ovidiu				Scara		Titlu planşa		Forma	
				Ing. Calancea Darius				1:500		Obiect 2: Extindere canalizare menajera strada Jozsef Attila		A3	
				Proiectat								Planşa nr.	
				Proiect numar 13 - 2017								2_PS-01	
				Data august 2017									

PLAN DE SITUATIE - CANALIZARE MENAJERA

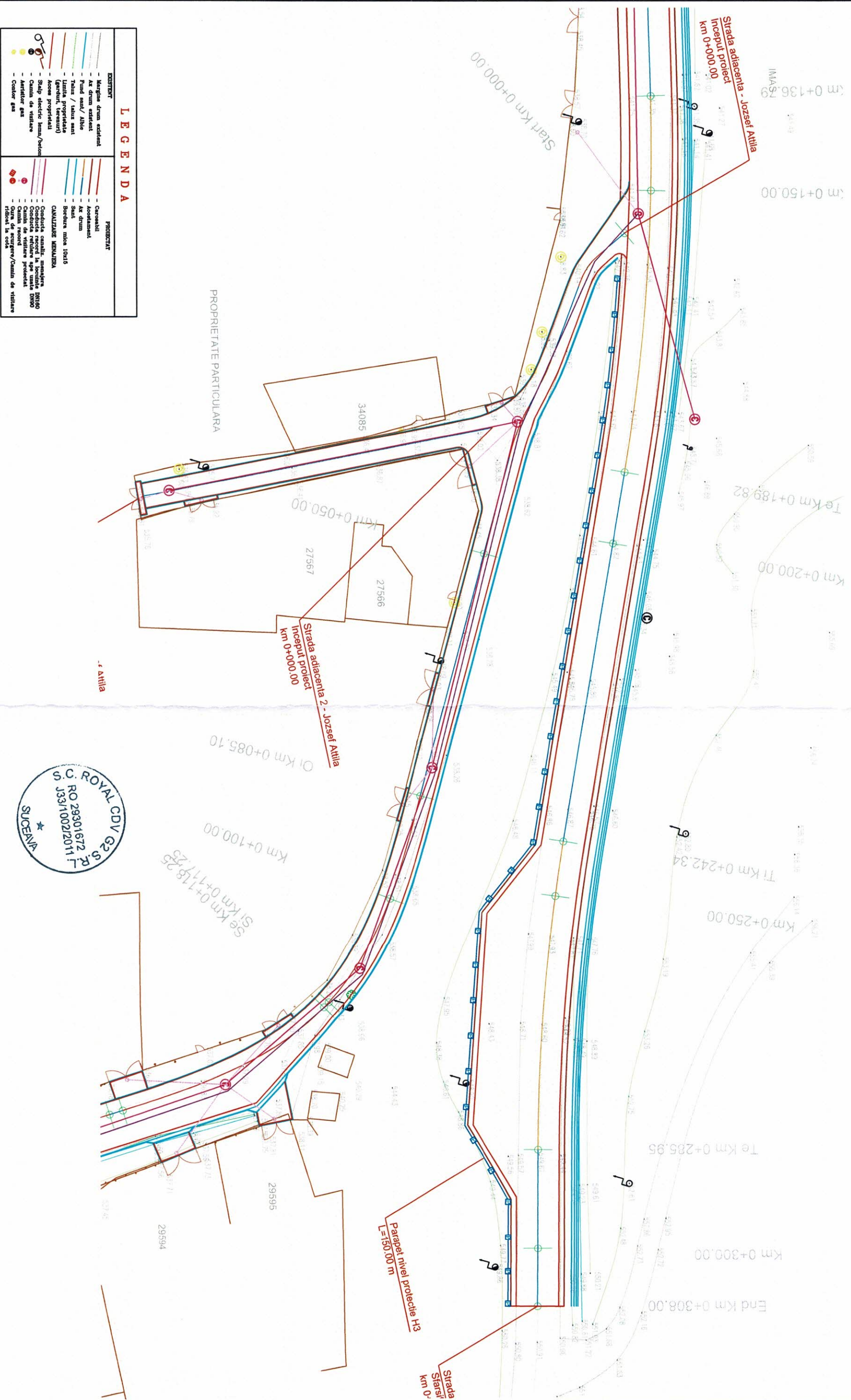

Proiectant		Beneficiar	
ROYAL CDV G2 RO29301672, Suceava, Romania		Municipiul Sfântu Gheorghe Jud. Covasna	
Verificator / Expert		Cerința	
Self proiect	Ing. Jilaniuc Robert	Faza	
Proiectat	Ing. Doroscan Ovidiu	D.A.L.I.	
Proiectat	Ing. Calancea Darius	Scara	
Proiect număr 13 - 2017	Data august 2017	Titlu planșă	
		Titlu proiect	
		Modernizare str. Jozsef Attila inclusiv rețele tehnico-edilitiare etapa III	
		Obiect 2: Extindere canalizare menajera strada Jozsef Attila	
		Revizia	
		00	
		Format	
		A3	
		Planșa nr.	
		2_PS-02	

PLAN DE SITUATIE - CANALIZARE MENAJERA

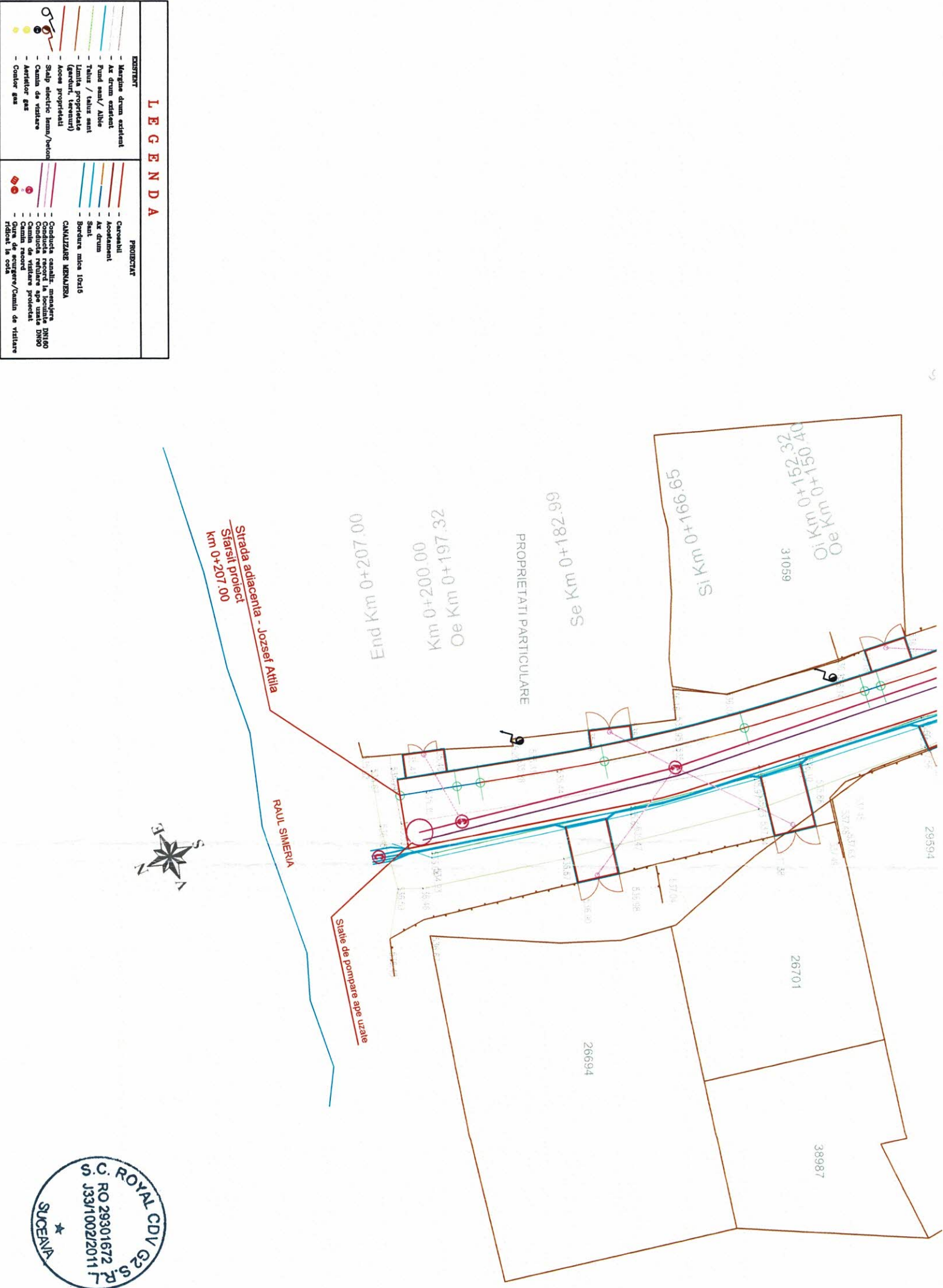

Proiectant		Beneficiar		Verificator / Expert		Faza		Titlu proiect		Revizia	
ROYAL CDV G2		Municipiul Stântu Gheorghe		Ing. Jitancu Robert		D.A.L.I.		Modernizare str. Jozsef Attila inclusiv retele tehnico-edilitare etapa III		00	
RO29301672, Suceava, Romania		Jud. Covasna		Ing. Doroscan Ovidiu		Scara		Titlu planşa		Format	
				Ing. Calancea Darius		1:500		Obiect 2: Extindere canalizare menajera strada Jozsef Attila		A3	
				Proiect numar 13 - 2017		Data		august 2017		Planşa nr.	
										2_PS-03	